

**Quick Guide**

# Steritest® Sampling

## Needle Guide Sampling Kit TZSPLKT10



The life science business of  
Merck operates as MilliporeSigma  
in the US and Canada.

## Installing the Needle Guide

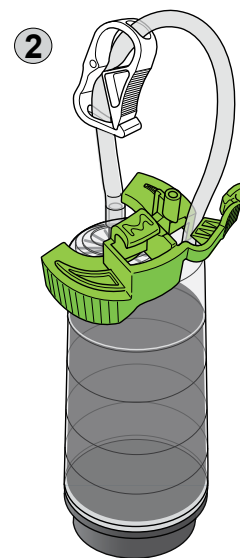
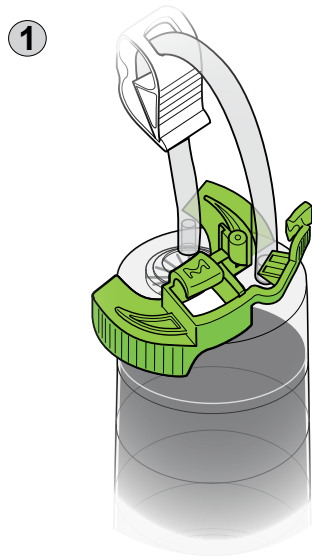

- When sampling is required, transfer the canister in a biosafety cabinet and decontaminate the tubing from the clamp to the chimney. Install the Needle Guide on the top of the canister, around the vent filter. (1) Make sure the tubing is inserted inside the open clamp. (2)

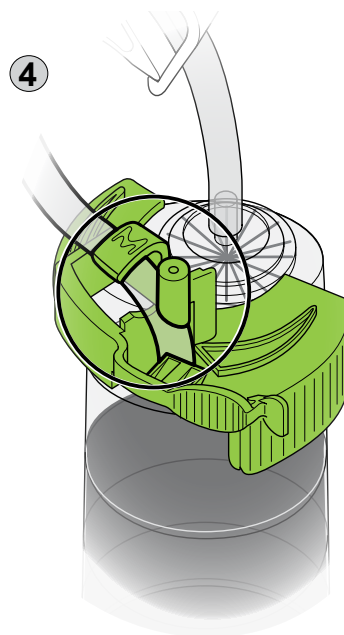
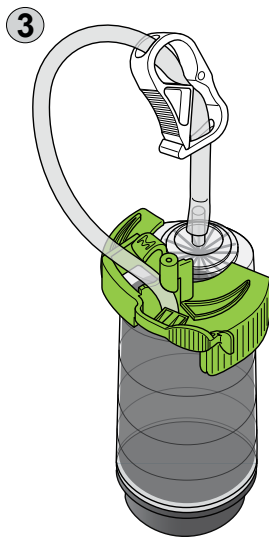

- Grab the tubing and place it in the hook to secure the guide in place and keep the tubing bent. (3–4)

## Sampling from the canister

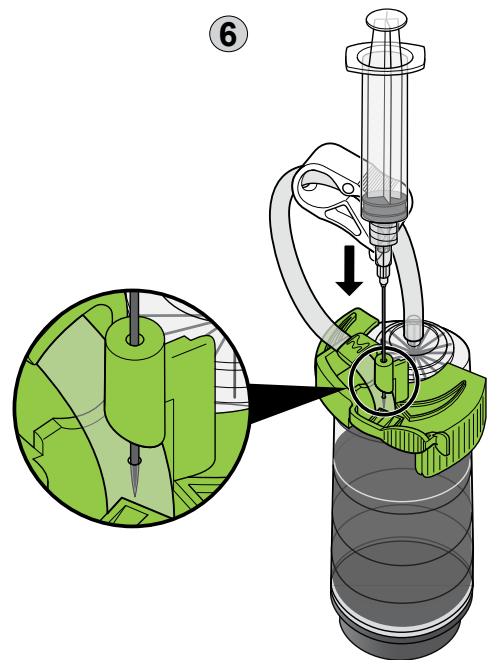
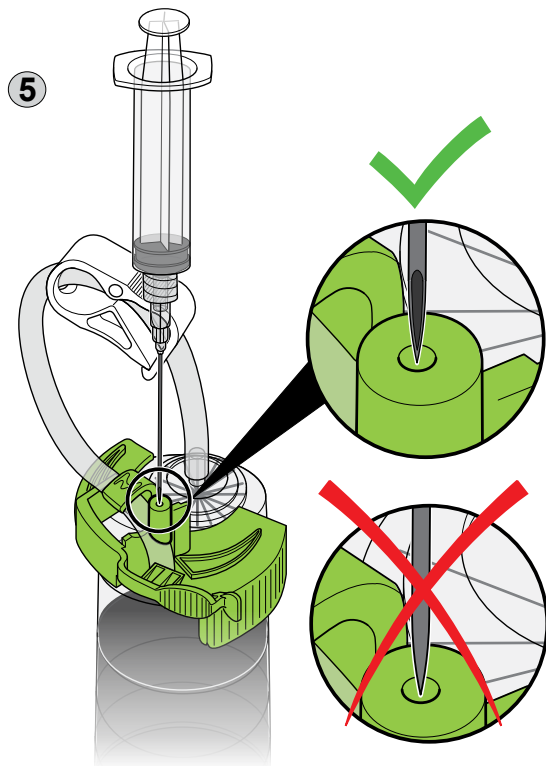

- Connect the needle to a syringe and insert it into the barrel. Index the bevel of the needle as shown to achieve a straight pierce through the tubing. (5)
- Insert the needle straight down to pierce the tubing and enter the canister chimney. (6)

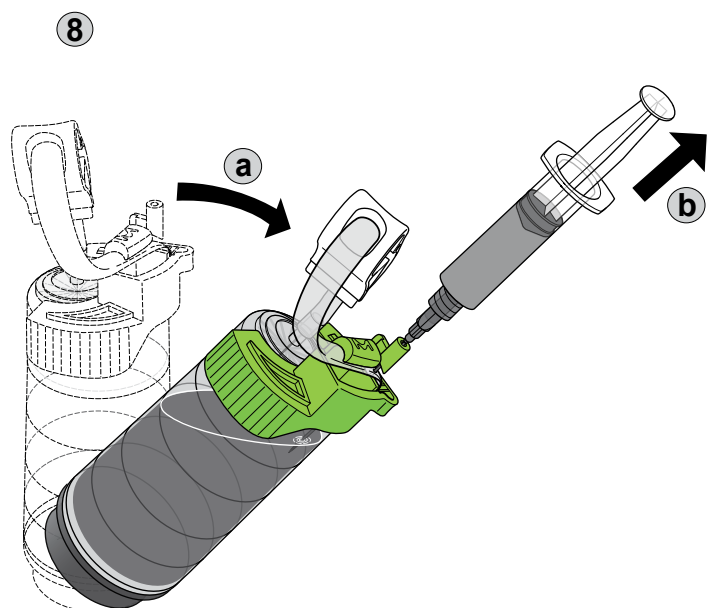
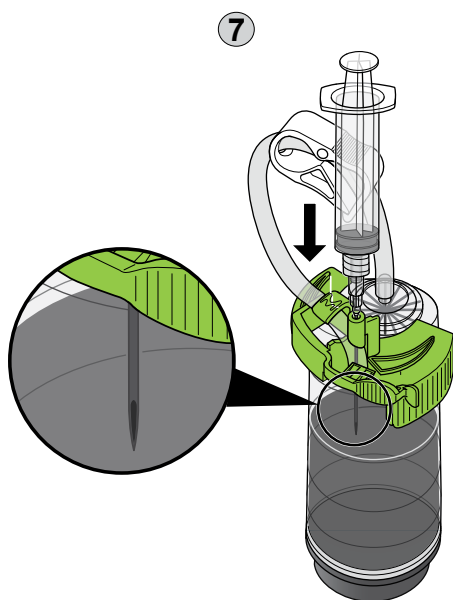

- Once fully down, tilt the canister to access the media and sample. (7-8)

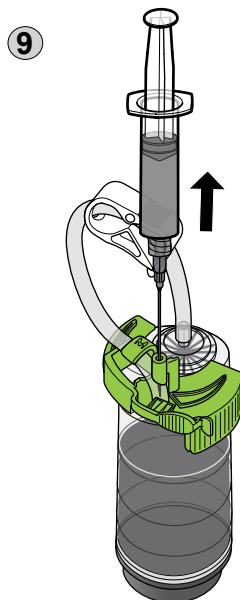

- Remove the syringe and transfer the liquid to the desired container. (9)

## After sampling

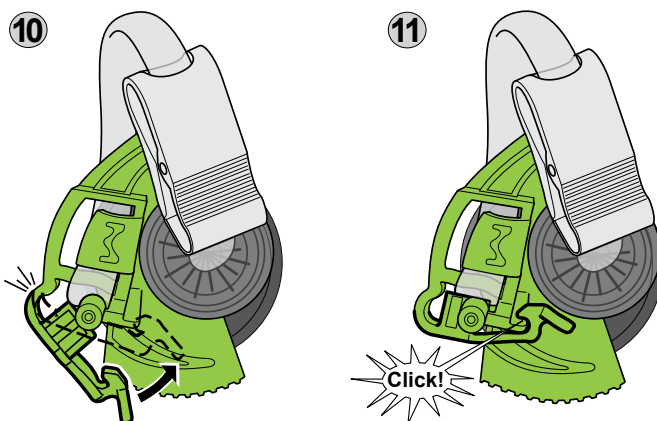

- Close the clamp to close the tubing. (10–11)

Merck KGaA  
Frankfurter Strasse 250  
64293 Darmstadt, Germany

## Technical Assistance

Please check the product webpage to see if an updated version of this user guide is available. For more information visit [www.sigmaaldrich.com/techservice](http://www.sigmaaldrich.com/techservice)

[SigmaAldrich.com/sterility-testing](http://SigmaAldrich.com/sterility-testing)

